

0m 1m 2m 3m

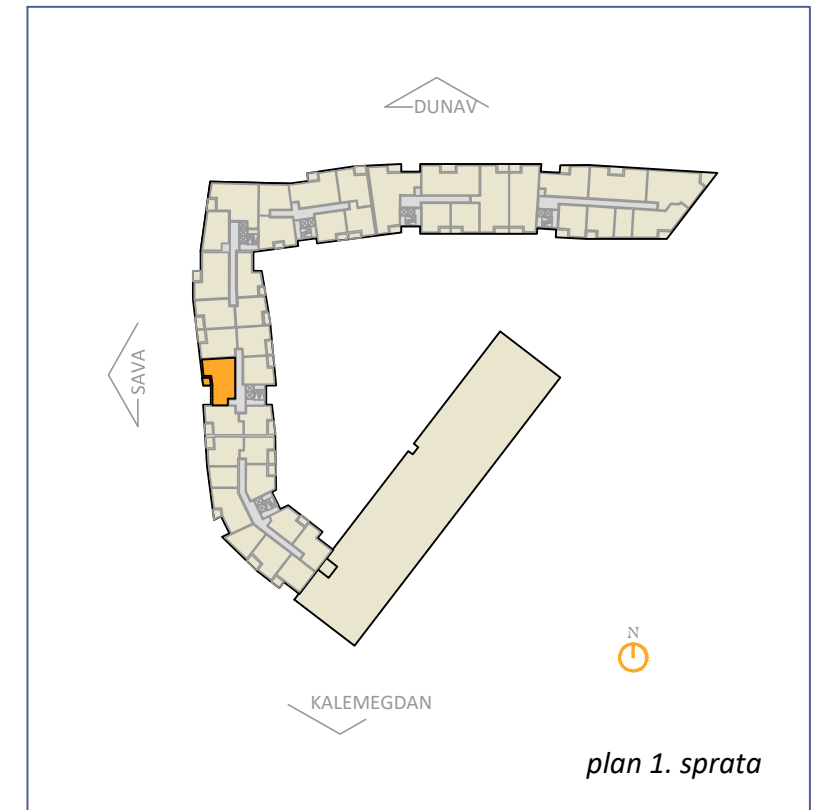

POVRŠINA STANA	74.38 m ²
APARTMENT AREA	
POVRŠINA TERASA	3.01 m ²
TERRACE AREA	
UKUPNA POVRŠINA	77.39 m²
TOTAL AREA	

8.1.3
8.2.2
8.3.2
8.4.2
8.5.2
8.6.2

TROSOBAN STAN