

0m 1m 2m 3m

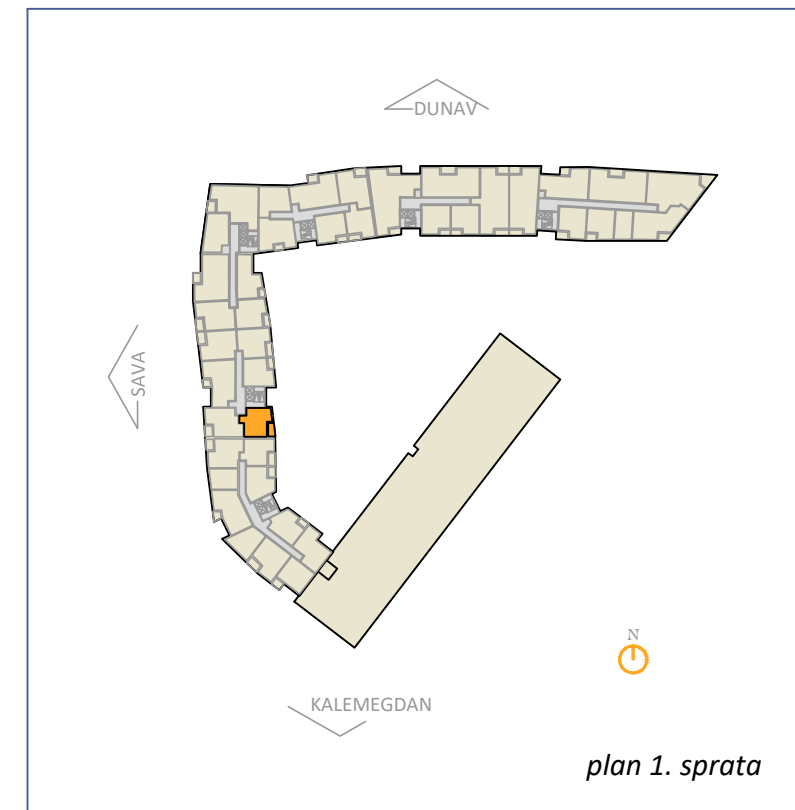

POVRŠINA STANA 52.83 m<sup>2</sup>  
APARTMENT AREA

POVRŠINA TERASA 3.30 m<sup>2</sup>  
TERRACE AREA

**UKUPNA POVRŠINA 56.14 m<sup>2</sup>**  
**TOTAL AREA**

**8.1.1**

**DVOSOBAN STAN**