

0m 1m 2m 3m

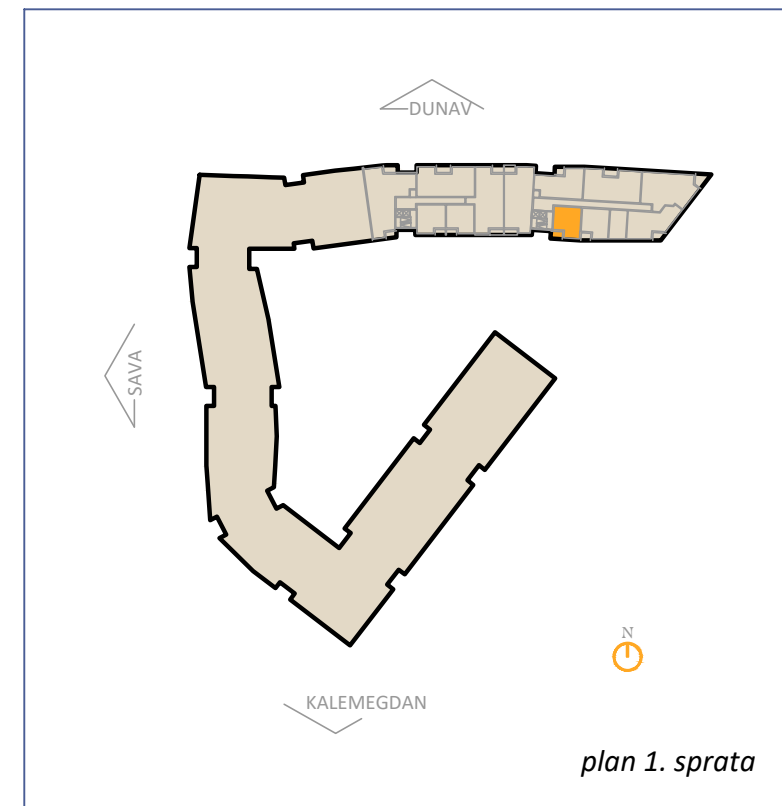

POVRŠINA STANA 48.67m²
 APARTMENT AREA

POVRŠINA TERASA 5.16m²
 TERRACE AREA

UKUPNA POVRŠINA 53.83m²
 TOTAL AREA

12.1.8

12.2.8

12.3.8

12.4.8

DVOSOBAN STAN